

# Kidde Fire Systems System Component Datasheet



Effective: December 2018  
K-85-0502 Rev AB

## Cylinder Mounting Straps

### FEATURES

- For Approvals, see the “COMPATIBILITY” table on page 2.

Steel straps and brackets are used to mount the cylinders in a vertical position. Cylinder straps (P/N WK-283945-000, WK-283934-000, 06-235317-001, WK-281866-000, WK-294651-000, 06-236125-001 and 30710193) are available for all size cylinders.

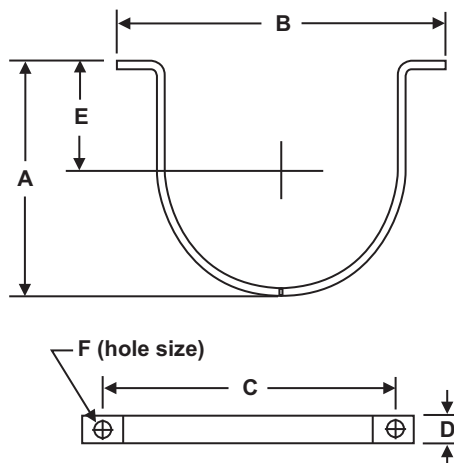

Part Number	Cylinder Size	Cylinder O.D.	Dimension A	Dimension B	Dimension C	Dimension D	Dimension E	Dimension F
WK-283945-000	10 lb., 20 lb.	7.07 in. (180 mm)	6.48 in. (165 mm)	9.62 in. (224 mm)	8.62 in. (219 mm)	1 in. (25 mm)	2.78 in. (71 mm)	0.437 in. (11 mm)
WK-283934-000	40 lb., 70 lb.	9 in. (229 mm)	8.16 in. (207 mm)	11.69 in. (297 mm)	10.69 in. (272 mm)	1 in. (25 mm)	3.50 in. (89 mm)	0.437 in. (11 mm)
06-235317-001	125 lb., 200 lb., 225 lb.*	12.75 in. (324 mm)	12.93 in. (329 mm)	16.18 in. (411 mm)	14.56 in. (370 mm)	1.75 in. (44 mm)	5.59 in. (142 mm)	0.625 in. (16 mm)
WK-281866-000	350 lb., 395 lb.*	16 in. (406 mm)	15.50 in. (394 mm)	19.50 in. (495 mm)	17.88 in. (454 mm)	1.75 in. (44 mm)	6.06 in. (154 mm)	0.625 in. (16 mm)
WK-294651-000	600 lb., 675 lb.*	22 in. (559 mm)	21.56 in. (548 mm)	25.75 in. (654 mm)	24.12 in. (613 mm)	1.75 in. (44 mm)	10.25 in. (260 mm)	0.625 in. (16 mm)
06-236125-001	900 lb., 1010 lb.*	24 in. (610 mm)	23.75 in. (603 mm)	27.75 in. (705 mm)	26 in. (660 mm)	1.75 in. (44 mm)	12.13 in. (308 mm)	0.625 in. (16 mm)
30710193	1100 lb.**	30 in. (762 mm)	30-1/8 in. (765 mm)	34-1/4 in. (870 mm)	32-1/4 in. (819 mm)	1-1/2 in. (38 mm)	15 in. (381 mm)	7/16 in. (11 mm)

\* 225, 395, 675, and 1010 lb cylinders are only applicable to Kidde® ADS™ with HFC-227ea systems.

\*\* 1100 lb. Cylinder is only available for Kidde® ECS-500™ System land-based systems.

**MATERIALS**

- Steel, Painted Black SAE 1020

**COMPATIBILITY**

Series	DIOM P/N	Approvals
Kidde® ECS-500™ System	06-237585-001	UL, ULC, FM
Kidde® ECS-500™ Marine System	06-237589-001	UL, ULC, USCG
Kidde® ECS™ with 3M™ Novec™ 1230 Fire Protection Fluid	06-236553-001	UL, ULC, FM
Kidde® ADS™ with 3M™ Novec™ 1230 Fire Protection Fluid	06-237256-001	UL, ULC, FM
Kidde® ECS™ Marine with 3M™ Novec™ 1230 Fire Protection Fluid	06-236559-001	UL, ULC, USCG
Kidde® ADS™ Marine with 3M™ Novec™ 1230 Fire Protection Fluid	06-237257-001	UL, ULC, USCG
Kidde® ECS™ with HFC-227ea Agent	06-236115-001	UL, ULC, FM
Kidde® Modular ECS™ with HFC-227ea Agent	06-236116-001	UL, ULC, FM
Kidde® ECS™ Marine with HFC-227ea Agent	06-236225-001	UL, USCG
Kidde® ADS™ Marine with HFC-227ea Agent	06-236595-001	UL, ULC, USCG
Kidde® ADS™ with HFC-227ea Agent	06-236068-001	UL, ULC, FM

Agent	Series	Cylinder Size							
		10, 20 lb	40, 70 lb	125 lb	200/ 225* lb	350/ 395* lb	600/ 675* lb	900/ 1010* lb	1100 lb**
3M Novec 1230 Fire Protection Fluid	ECS-500 System	X	X	X	X	X	X	X	X
	ECS 360	X	X	X	X	X	X	X	
	ADS				X	X	X	X	
HFC-227ea Agent	ECS 360	X	X	X	X	X	X	X	
	ECS 360 Modular	X	X	X	X	X	X		
	ADS				X	X	X	X	

\* 225, 395, 675, and 1010 lb cylinders are only applicable to Kidde ADS™ with HFC-227ea systems.

\*\* 1100 lb. Cylinder is only available for Kidde ECS-500™ System land-based systems.

**EXPORT INFORMATION (USA)**

Jurisdiction: EAR

Classification: EAR99

This document contains technical data subject to the EAR.

KIDDE is a registered trademark of Kidde-Fenwal, Inc., or its parents, subsidiaries or affiliates.

This literature is provided for informational purposes only. KIDDE-FENWAL, INC. believes this data to be accurate, but it is published and presented without any guarantee or warranty whatsoever. KIDDE-FENWAL, INC. assumes no responsibility for the product's suitability for a particular application. Product features specified are only applicable when the fire suppression system is correctly designed, installed, maintained and serviced by trained, authorized Kidde Fire Systems distributors as per the applicable design, installation, operation, and maintenance manuals. If you need more information on this product, or if you have a particular problem or question, contact: KIDDE-FENWAL, INC., Ashland, MA 01721 USA, Telephone: (508) 881-2000.

